

Vértice	X	Y
P.2755	-40118,237	-162705,744
P.2757	-40032,334	-162857,985
P.2759	-39952,855	-162614,52
P.2761	-39908,244	-162889,763
P.2763	-39901,554	-162886,121
P.2765	-39882,773	-162575,848
P.2767	-39780,655	-162819,36
P.2769	-39706,656	-16275,184
P.2771	-39646,424	-162445,686
P.2773	-39576,373	-162407,748
P.2775	-39557,412	-162396,607
P.2777	-39494,493	-162365,846

Vértice	X	Y
P.2978	-40092,434	-162741,856
P.2980	-40076,101	-162233,477
P.2982	-40058,91	-162223,195
P.2984	-40027,211	-162704,89
P.2986	-39983,74	-162680,389
P.2988	-39939,671	-162656,098
P.2990	-39896,216	-162631,687
P.2992	-39852,632	-162607,494
P.2994	-39808,693	-162583,159
P.2996	-39765,46	-162551,079
P.2998	-39722,209	-162525,359
P.3000	-39683,416	-162501,807
P.3002	-39649,91	-162477,244
P.3004	-39616,611	-162455,506
P.3006	-39587,629	-162422,799

SIMBOLOGIA VEDAÇÕES

VEDAÇÃO - EXISTENTE A DEMOLIR
 VEDAÇÃO - EXISTENTE A MANTER
 VEDAÇÃO TIPO II - EXISTENTE A SUBSTITUIR
 VEDAÇÃO TIPO II - NOVA

SIMBOLOGIA CAMINHOS PARALELOS

CAMINHO PARALELO TIPO I
 CAMINHO PARALELO TIPO II

PORTÃO DE EMERGÊNCIA
 PORTAS DE SAÍDA (UNIDIRECCIONAL)
 VÉRTICES COORDENADOS DE VEDAÇÃO
 PONTOS DE CONTACTO (A DEFINIR EM OBRA DE ACORDO COM DESENHOS DE PORMENOR)

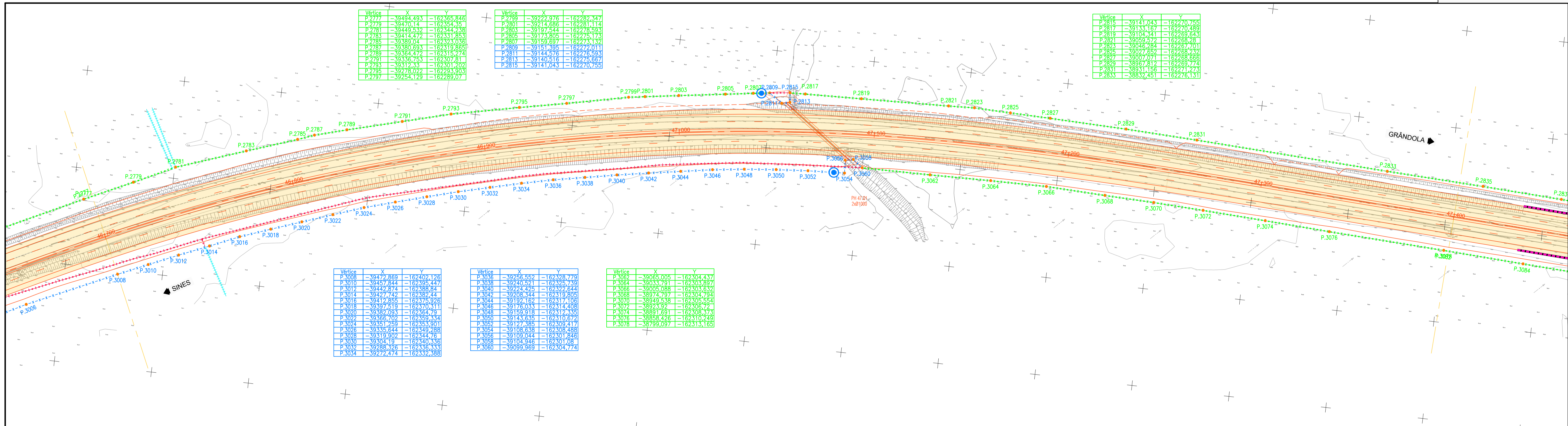

Vértice	X	Y
P.2779	-39494,493	-162265,846
P.2781	-39470,14	-162354,35
P.2783	-39449,542	-162442,838
P.2785	-39414,922	-162331,853
P.2787	-39389,04	-162323,036
P.2789	-39360,693	-162319,665
P.2791	-39335,422	-162315,274
P.2793	-39312,43	-162307,811
P.2795	-39293,922	-162301,202
P.2797	-39254,129	-162283,07

Vértice	X	Y
P.2801	-39222,076	-162269,547
P.2803	-39197,454	-162278,693
P.2805	-39173,205	-162275,173
P.2807	-39159,697	-162273,159
P.2809	-39151,395	-162272,011
P.2811	-39144,578	-162276,593
P.2813	-39140,518	-162275,662
P.2815	-39141,043	-162270,755

Vértice	X	Y
P.2815	-39141,043	-162270,755
P.2817	-39133,162	-162270,499
P.2819	-39104,541	-162269,643
P.2821	-39069,672	-162265,26
P.2823	-39046,284	-162267,011
P.2825	-39027,692	-162268,232
P.2827	-39007,071	-162265,666
P.2829	-38987,812	-162269,774
P.2831	-38961,169	-162274,223
P.2833	-38932,451	-162276,131

Vértice	X	Y
P.3008	-38472,869	-162402,126
P.3010	-38457,844	-162395,447
P.3012	-38442,374	-162388,24
P.3014	-38427,742	-162382,44
P.3016	-38412,855	-162375,925
P.3018	-38397,516	-162370,111
P.3020	-38382,093	-162364,19
P.3022	-38366,709	-162358,32
P.3024	-38351,256	-162353,001
P.3026	-38335,644	-162349,288
P.3028	-38319,902	-162344,76
P.3030	-38304,119	-162340,164
P.3032	-38288,326	-162335,333
P.3034	-38272,474	-162331,388

Vértice	X	Y
P.3036	-38256,552	-162328,779
P.3038	-38240,591	-162325,739
P.3040	-38224,425	-162322,644
P.3042	-38208,344	-162319,805
P.3044	-38192,162	-162317,108
P.3046	-38176,033	-162314,408
P.3048	-38159,918	-162311,735
P.3050	-38143,635	-162310,672
P.3052	-38127,285	-162309,417
P.3054	-38110,638	-162308,488
P.3056	-38109,044	-162301,848
P.3058	-38104,266	-162301,08
P.3060	-38099,989	-162304,774

Vértice	X	Y
P.3062	-38065,005	-162304,437
P.3064	-38033,791	-162303,897
P.3066	-38005,086	-162303,631
P.3068	-38974,797	-162304,294
P.3070	-38949,538	-162305,554
P.3072	-38923,392	-162306,42
P.3074	-38891,691	-162308,373
P.3076	-38858,426	-162310,249
P.3078	-38825,097	-162313,165