

Edifício 3B - Nova Unidade de Pintura – Redes de Infra-estruturas

- . 4300-00000-00-L9-SE_22108_Utility_LP3-104-VAA-01 – Planta de Infra-estruturas
- . 4300-00000-00-L9-SE_22108_RW_LP3-104-VAA-01 – Rede de Águas Pluviais
- . 4300-00000-00-L9-SE_22108_IWW_LP3-104-VAA-01 – Rede de Águas Residuais Industriais
- . 4300-00000-00-L9-SE_22108_WW_LP3-104-VAA-01 – Rede de Águas Residuais Domésticas

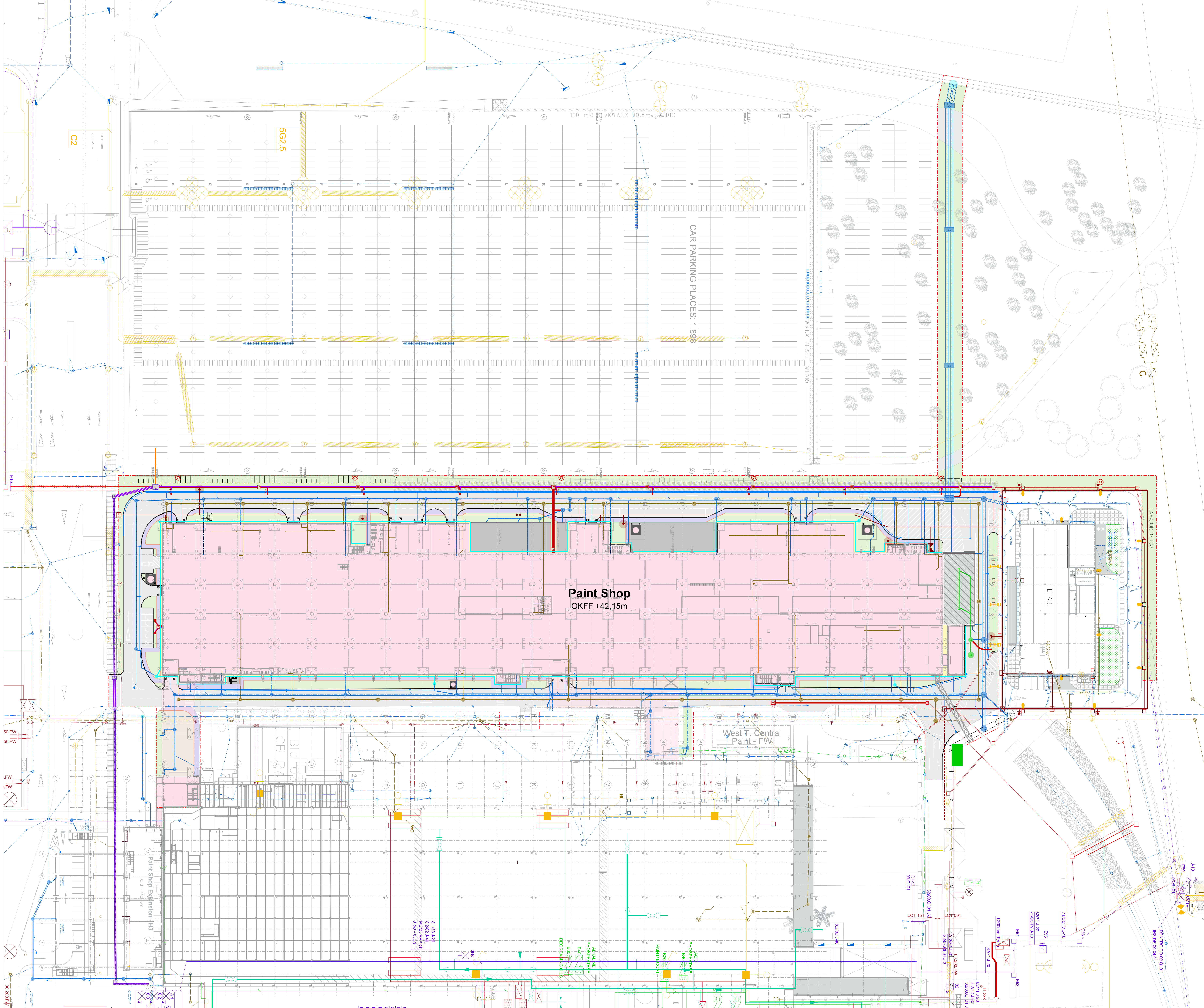

Legende

	Planning	Existing
Construction boundary		
Curbstone high		
Curbstone low		
Factory fence		
Railtrack		
Tree		
Light pole		
Camera		
E-Charging station		
Street inlet		
Rainwater pavement channel		
Rainwater drainage channel		
Rainwater manhole		
Rainwater pipe		
Drainage pipe		
Drainage manhole		
Drainage inspection pit		
Industrial wastewater channel		
Industrial wastewater manhole		
Industrial wastewater pipe		
Wastewater manhole		
Wastewater pipe		
Extinguishing Water pipe (Planning by IBZ)		
Fire Hydrant above ground		
Electrical manhole		
Electrical cable conduits		
Telecommunication line		
Cable duct light pole		
Potable water		
Irrigation pipe		
Irrigation valve		

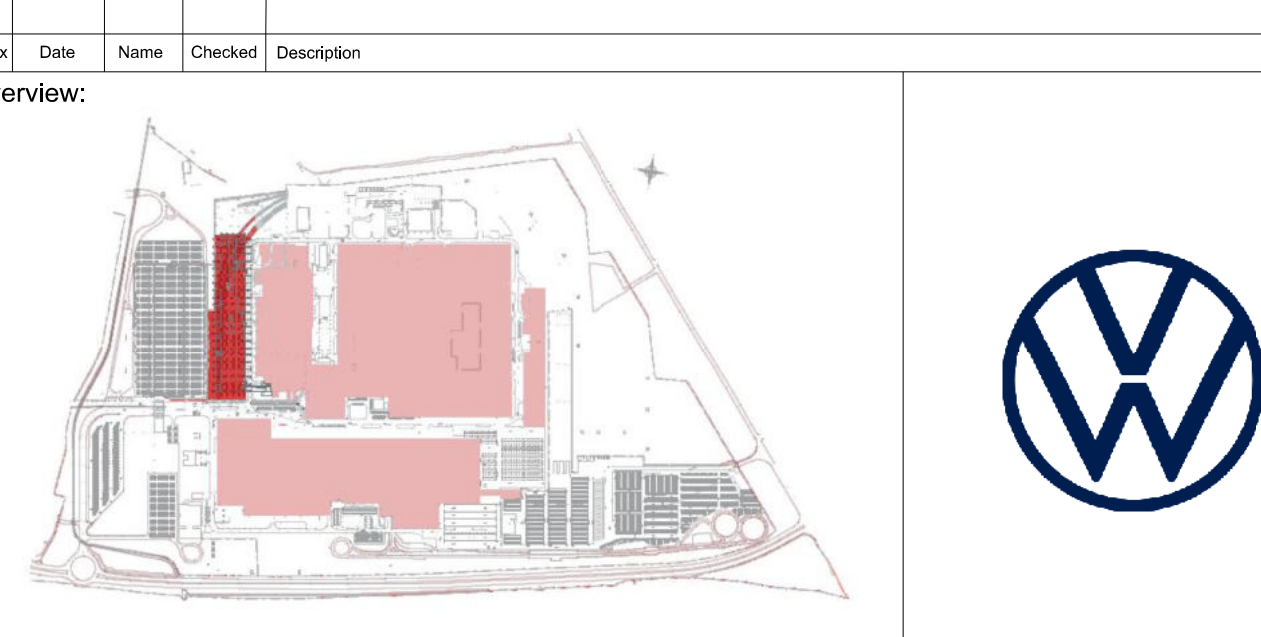

Overview: 			
CAD-System:	MicroStation / HLS		
Client:	Volkswagen AG / PPB-C Fabrikplanung Wolfsburg		
Specialist Planner: Building Services	Ingenieurbüro Zammit GmbH, TB Celle Hogrevestraße 25 D-29223 Celle Tel: +49 (0) 5141-93492 150 Fax: +49 (0) 5141-93492 159 E-Mail: mail@ibz-ppp.de www.ibz-zammit.de		
Architect:	Architekten Ingenieure PSP Goldbekplatz 2 D - 22303 Hamburg T: +49(0)40 / 27 84 89 0 F: +49(0)40 / 27 84 89 59 E-Mail: mail@arch-ppp.de www.arch-ppp.de		
Specialist Planner: Infrastructure	Sellhorn Ingenieurgesellschaft mbH Teufelfeld 5, D-20459 Hamburg Tel: +49 (0)40 36 12 01-0 Fax: +49 (0)40 36 12 01-28 E-Mail: info@sellhorn-hamburg.de www.sellhorn-hamburg.de		
Phase:	LP3 - Design Freeze	Sheet size: A0	
Scale:	1:500		
Project Title:	VW-AE New Paint Shop H3B, Palmela Utility Plan		
Designed:	tah	Date:	03.01.2024
Drawn:	tah	Checked:	sch
Planner:	4300-0000-00-L9-SE_22106_UTILITY_LP3-104-VAA	Checkdate:	03.01.2024
Signature/Release:		Index:	01

C:\Users\pawel\OneDrive\Desktop\WV_Plan_VW-AE-New-Paint-Shop-H3B_Palmela_VW-Projekt\LP3-104-VAA_22106_UTILITY_LP3-104-VAA.dwg, 02.01.2024, 10:00:00

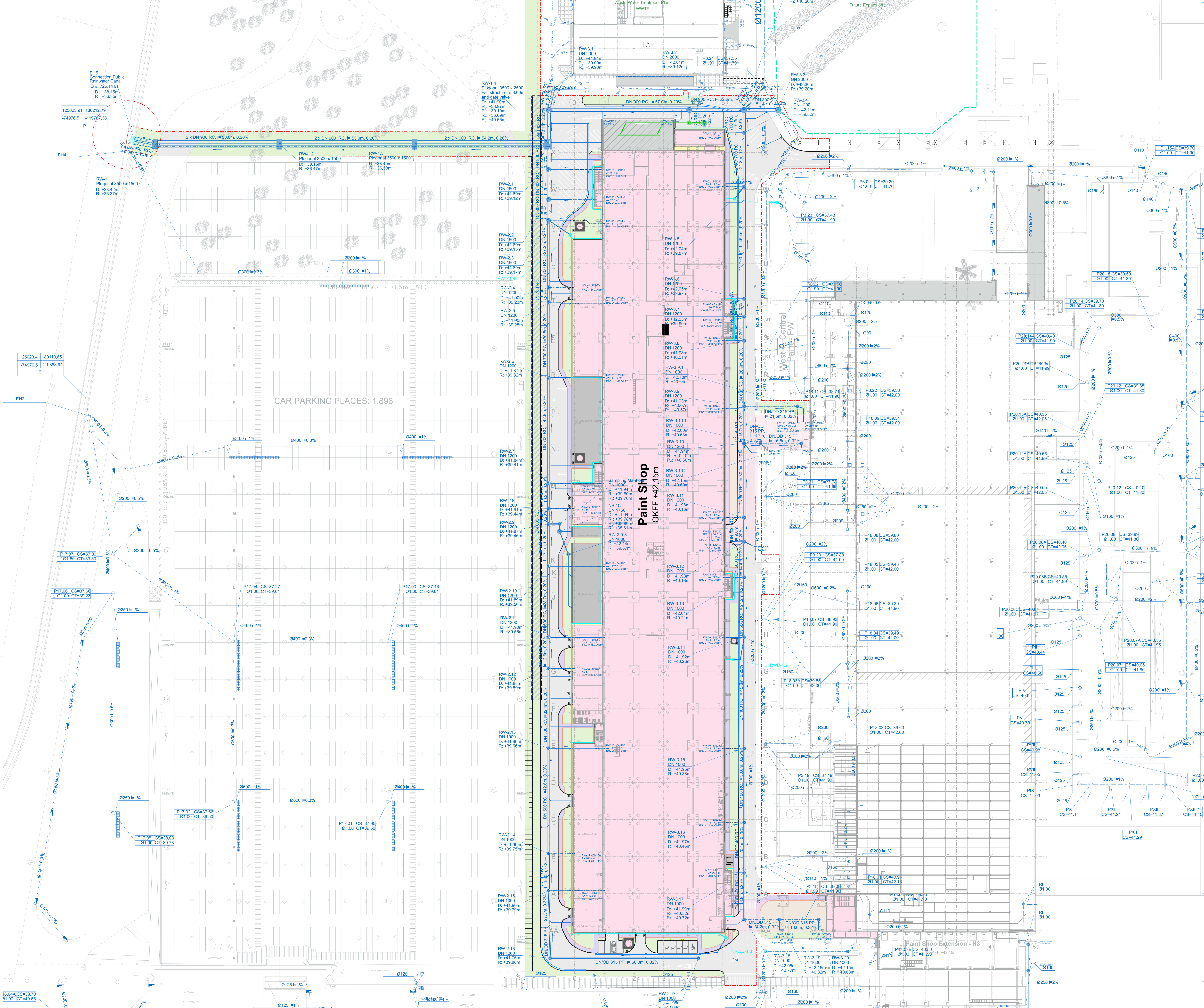

Legende

	Planning	Existing
Building		
Asphalt pavement		
Concrete platform		
Logistics area		
Gravel strip		
Concrete block pavement - Sidewalk		
Green area		
Construction boundary		
Curbstone high		
Curbstone low		
Factory fence		
Light pole		
Tree		
Railtrack		
Street inlet		
Rainwater pavement channel		
Rainwater drainage channel		
Rainwater pipe		
Rainwater manhole		
Rainwater pipe		
*Planning by third parties/ future expansion		
Drainage pipe		
Drainage manhole		
Drainage inspection pit		
Industrial Wastewater pipe		
Industrial Wastewater manhole		

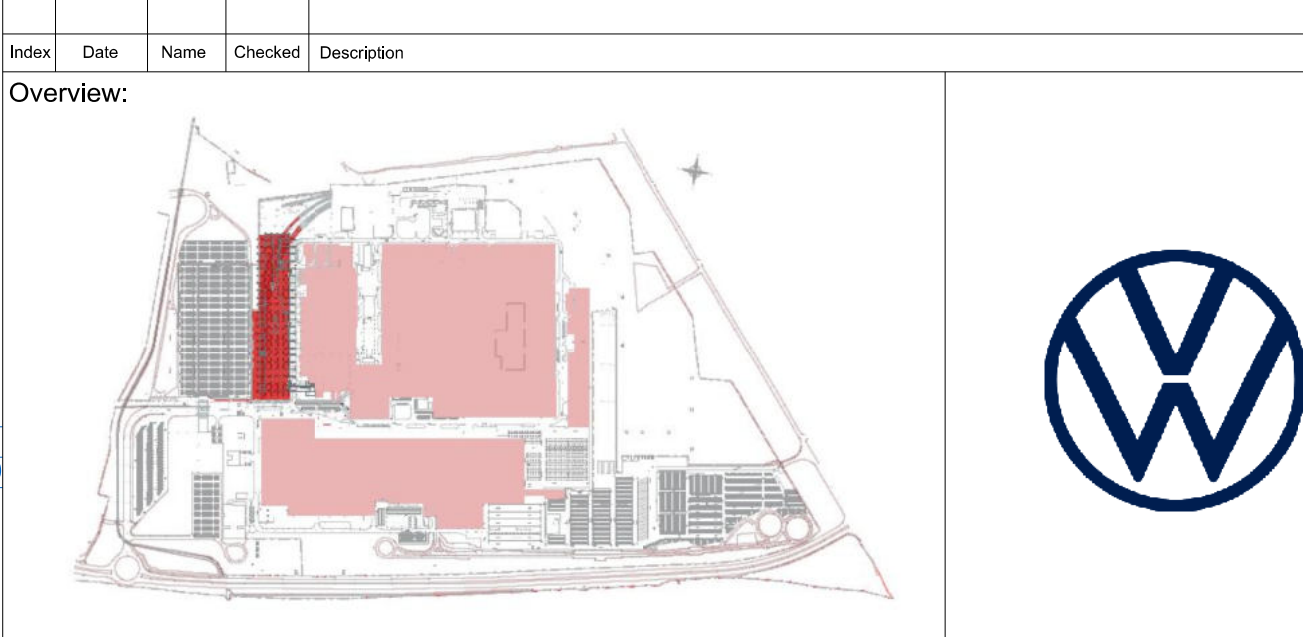
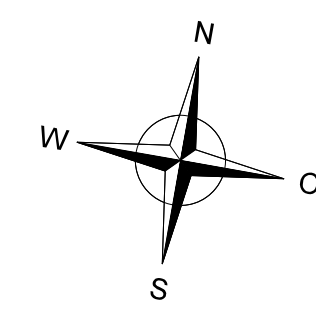

Overview:

CAD-System: MicroStation / HLS

Client: Volkswagen AG / PPB-C
Fabrikplanung Wolfsburg

Specialist Planner:
Building Services: Ingenieurbüro Zammit GmbH, TB Celle
Hogrefestraße 25
D-39223 Celle
Tel: +49 (0) 5141 - 93492 150 | Fax: +49 (0) 5141 - 93492 159
E-Mail: mail@ibzammit.de
www.ibzammit.de

Architect: Architekten Ingenieure PSP
Goldbekplatz 2
D - 22303 Hamburg
T: +49(0)40 127 84 89 0 | F: +49(0)40 / 27 84 89 59
E-Mail: mail@arch-psp.de
www.arch-psp.de

Specialist Planner:
Infrastructure: Sellhorn Ingenieurgesellschaft mbH
Teufelhof 5, D-20459 Hamburg
Tel: +49 (0)40 36 12 01-0 | Fax: +49 (0)40 36 12 01-28
E-Mail: info@sellhorn-hamburg.de
www.sellhorn-hamburg.de

Phase: LP3 - Design Freeze

Scale: 1:500

Project Title: VW-AE New Paint Shop H3B, Palmela

Plan Title: Rainwater Network

Designed: tah Date: 03.01.2024

Drawn: tah Check: schm

Planner: 4300-0000-00-49-SE_22108_LP3-104-VAA

Signature/Release:

Sheet size: A0

Checkdate: 03.01.2024

Index: 01