

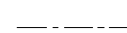





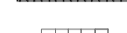

SIMBOLOGIA / SYMBOLS

-  EIXO DA VIA / TRACK CENTRE
-  LIMITE DO EDIFÍCIO / BUILDING BOUNDARY
-  PIPERACK / PIPERACK
-  LUGAR DE ESTACIONAMENTO / CAR PARKING
-  LIMITE DO LOTE / LOT LIMIT
-  LINHAS ALTA TENSÃO / HIGH VOLTAGE LINES
-  PASSEIO / SIDEWALK
-  ZONAS VERDES / GREEN ZONES
-  VIAS INTERNAS / INTERNAL ROADS



PLANTA CHAVE / KEY PLAN

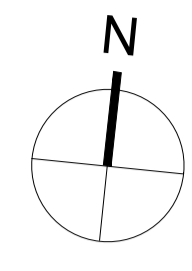
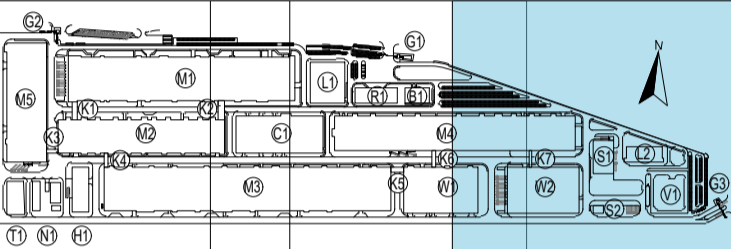

- M1 - PRODUÇÃO DE CÉLULAS / CELL WORKSHOP
- M2 - PRODUÇÃO DE CÉLULAS / CELL WORKSHOP
- M3 - FORMAÇÃO / FORMATION WORKSHOP
- M4 - EMBALAGEM / PACKING WORKSHOP
- M5 - PRODUÇÃO DE INVÓLUCROS / PARTS MANUFACTORY
- N1 - ESTATION DE WAP / WAP PURITY STATION
- H1 - ARMAZÉM DE QUÍMICOS / CHEMICAL STORAGE
- R1 - EDIFÍCIO R&D / R&D BUILDING
- T1 - ST&S / WWT
- B1 - INSTALAÇÕES PARA COLABORADORES / EMPLOYEE SERVICE CENTER
- C1 - ED. CENTRAL DE UTILIDADES / CENTRAL UTILITY BUILDING (CUB)
- S1 - ESTATION DE RESÍDUOS SÓLIDOS / S&W
- S2 - ESTATION DE RESÍDUOS LÍQUIDOS / GARBAGE STATION
- Kx - CORREDORES LOGÍSTICOS / LOGISTIC CORRIDORS
- L1 - LABORATÓRIO 1 / LABORATORY 1
- L2 - LABORATÓRIO 2 / LABORATORY 2
- G1 - PORTARIA 1 / GUARD HOUSE 1
- G2 - PORTARIA 2 / GUARD HOUSE 2
- G3 - PORTARIA 3 / GUARD HOUSE 3
- V1 - SUBESTACÃO PRINCIPAL / SUBSTATION
- W1 - ARMAZÉM DE CÉLULAS / CELL WAREHOUSE
- W2 - ARMAZÉM GERAL / GENERAL WAREHOUSE

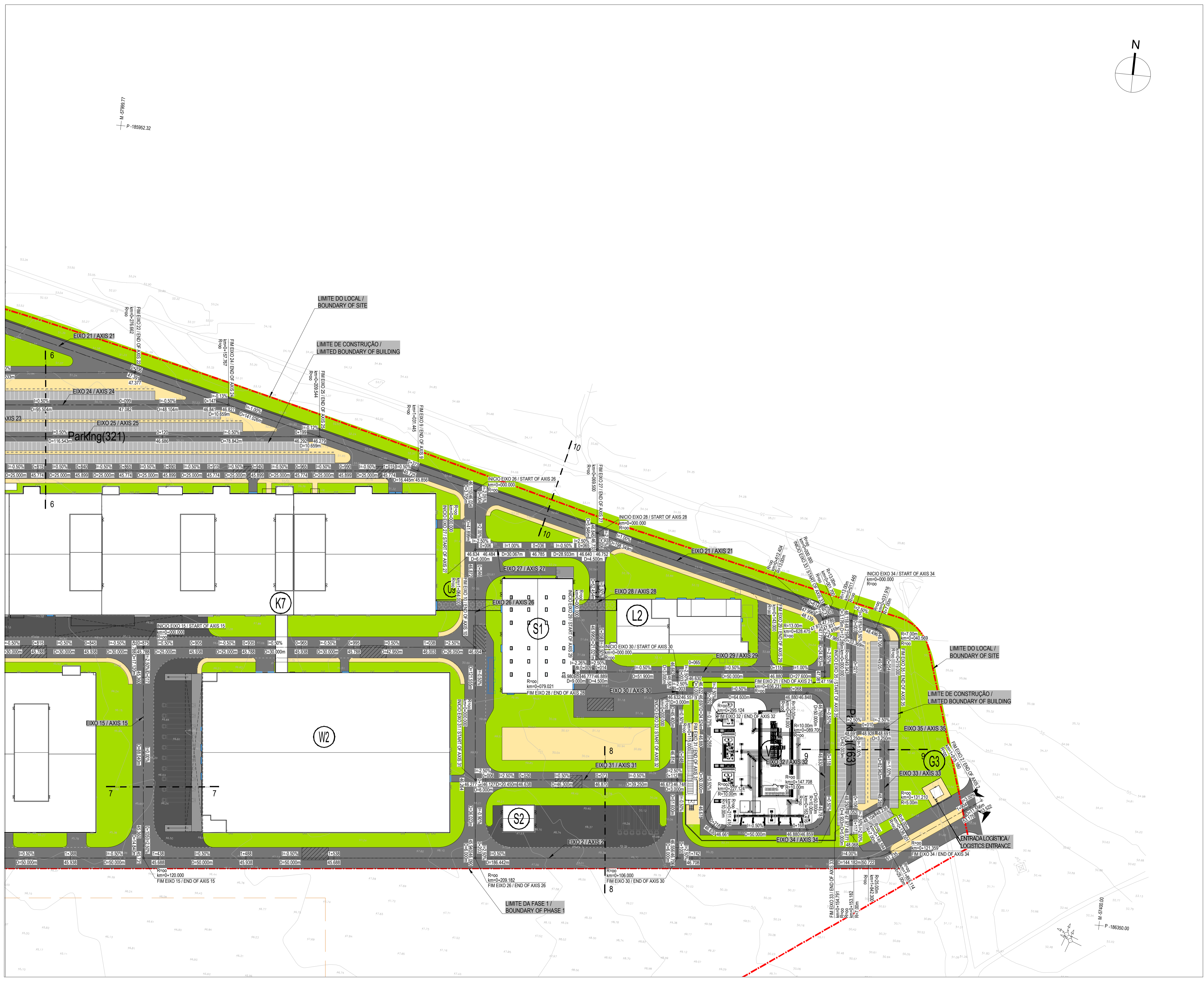

00	31.07.2023	EMISSÃO INICIAL / INITIAL ISSUE	MAA
Rev.	Date	Descrição das alterações / Description of changes	Aprov. / Approved



Ciente / Client
CALB

PROJETO / Project
UNIDADE INDUSTRIAL DE BATERIAS DE LÍTIU
LITHIUM BATTERY GIGAFACTORY PLANT

Fase / Phase
PROJETO DE EXECUÇÃO
DETAIL DESIGN

Designação / Designation
VIAS / ROADS
VIAS INTERNAS
PLANTA 3/3
INTERNAL ROADS
PLAN 3/3

Escala / Scale : 1:1000	Projeto / Designed : MXM
Data / Date : 31.07.2023	Desenho / Drawn : CAN
Processo / Process : T202-0519	Verificou / Checked : MAA
Arquivo / File : T202-0519-EX-ROA-GN-2003-DWG-00.dwg	Aprovou / Approved : FBM

Desenho / Drawing : **EX-ROA-GN-2003** 00

This drawing is property of QUADRANTE, Engenharia e Consultoria, S.A. It cannot be copied, partially or totally, or conveyed to third parties without written allowance from QUADRANTE, S.A. This drawing is only good for construction if properly signed.